

Aquaplus

**SD, SDA, SDL Series
Heavy Duty Submersible
Dewatering and
Drainage Pumps
415V**



**3 Year
Warranty!**

Dewatering Pumps

Heavy Duty Submersible Dewatering Drainage Pump 415V

Aquaplug SD Series 415V pumps are used extensively in applications such as construction dewatering and sump drainage. SD Series pumps are designed for continuous unattended operation.

Features

- Cast iron casing, ductile iron suction cover and chrome iron impeller
- Built in oil lifter enhances sealing life and performance
- Dual silicon carbide mechanical seals in an oil bath
- Pump can run in horizontal and vertical configurations
- Pump can run in “snore mode”

Applications

- General construction work
- Civil engineering
- Deep well applications

Specifications

| Model Number | Discharge (mm) | Power (kW) | Voltage (V) | Cable (m) | Max Flow (L/s) | Shut-off Head (m) | Pump Weight (kg) | Max Solid (mm) | Rated current A (415 V) |
|-----------------------|----------------|------------|-------------|-----------|----------------|-------------------|------------------|----------------|-------------------------|
| SD-50-52-1.5T2-20M-O | 50 | 1.5 | 415 | 20 | 6.6 | 22 | 30 | 8.5 | 3.3 |
| SD-80-52-1.5T2-20M-O | 80 | 1.5 | 415 | 20 | 11.2 | 14 | 30 | 8.5 | 3.3 |
| SD-50-52-2.2T2-20M-O | 50 | 2.2 | 415 | 20 | 8.2 | 26 | 34 | 8.5 | 5.6 |
| SD-80-52-2.2T2-20M-O | 80 | 2.2 | 415 | 20 | 16 | 18 | 34 | 8.5 | 5.6 |
| SD-50-52-3.7T2-20M-O | 50 | 3.7 | 415 | 20 | 7.5 | 36.5 | 56 | 8.5 | 7.3 |
| SD-80-52-3.7T2-20M-O | 80 | 3.7 | 415 | 20 | 16 | 27 | 56 | 8.5 | 7.3 |
| SD-100-52-3.7T2-20M-O | 100 | 3.7 | 415 | 20 | 24.1 | 18 | 56 | 8.5 | 7.3 |
| SD-80-52-5.5T2-20M-O | 80 | 5.5 | 415 | 20 | 22 | 33 | 71 | 8.5 | 10.5 |
| SD-100-52-5.5T2-20M-O | 100 | 5.5 | 415 | 20 | 30.5 | 23 | 71 | 8.5 | 10.5 |
| SD-100-52-7.5T2-20M-O | 100 | 7.5 | 415 | 20 | 21.4 | 39 | 96 | 8.5 | 13.8 |
| SD-150-52-7.5T2-20M-O | 150 | 7.5 | 415 | 20 | 36 | 33 | 98 | 20 | 13.8 |
| SD-100-52-11T2-20M-O | 100 | 11 | 415 | 20 | 24.1 | 47 | 132 | 8.5 | 20.5 |
| SD-150-52-11T2-20M-O | 150 | 11 | 415 | 20 | 40 | 32.5 | 135 | 20 | 20.5 |
| SD-100-52-15T2-20M-O | 100 | 15 | 415 | 20 | 24 | 56 | 145 | 11.5 | 29.5 |
| SD-150-52-15T2-20M-O | 150 | 15 | 415 | 20 | 44 | 40 | 149 | 19.5 | 29.5 |

Dimensions



1.5kW - 5.5kW

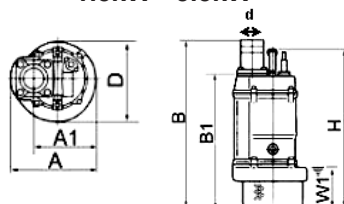

7.5kW - 15kW

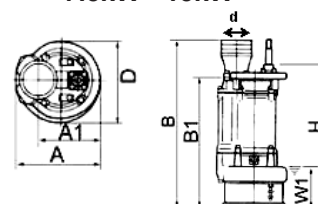

| Model | Dimensions (mm) | | | | | | | |
|-----------------------|-----------------|-----|-----|-----|-----|-----|-----|-----|
| | D | H | A | A1 | B | B1 | W1 | d |
| SD-50-52-1.5T2-20M-O | 216 | 486 | 235 | 173 | 597 | 409 | 120 | 50 |
| SD-80-52-1.5T2-20M-O | 216 | 486 | 235 | 173 | 597 | 409 | 120 | 80 |
| SD-50-52-2.2T2-20M-O | 216 | 486 | 235 | 173 | 517 | 412 | 120 | 50 |
| SD-80-52-2.2T2-20M-O | 252 | 638 | 283 | 208 | 628 | 523 | 150 | 80 |
| SD-50-52-3.7T2-20M-O | 216 | 486 | 235 | 173 | 517 | 394 | 120 | 50 |
| SD-80-52-3.7T2-20M-O | 252 | 638 | 283 | 208 | 628 | 508 | 150 | 80 |
| SD-100-52-3.7T2-20M-O | 259 | 598 | 306 | 218 | 671 | 536 | 150 | 100 |
| SD-80-52-5.5T2-20M-O | 525 | 638 | 283 | 208 | 642 | 523 | 150 | 80 |
| SD-100-52-5.5T2-20M-O | 259 | 598 | 306 | 218 | 686 | 547 | 150 | 100 |
| SD-100-52-7.5T2-20M-O | 314 | 676 | 330 | 240 | 764 | 626 | 190 | 100 |
| SD-150-52-7.5T2-20M-O | 314 | 676 | 330 | 240 | 790 | 626 | 190 | 150 |
| SD-100-52-11T2-20M-O | 350 | 695 | 373 | 255 | 807 | 641 | 190 | 100 |
| SD-150-52-11T2-20M-O | 350 | 695 | 373 | 255 | 807 | 631 | 190 | 150 |
| SD-100-52-15T2-20M-O | 350 | 755 | 373 | 255 | 842 | 666 | 190 | 100 |
| SD-150-52-15T2-20M-O | 350 | 755 | 373 | 255 | 842 | 666 | 190 | 150 |

All content is subject to change without notice.

Heavy Duty Submersible Dewatering Drainage Pump 415V (cont.)

Performance Curves

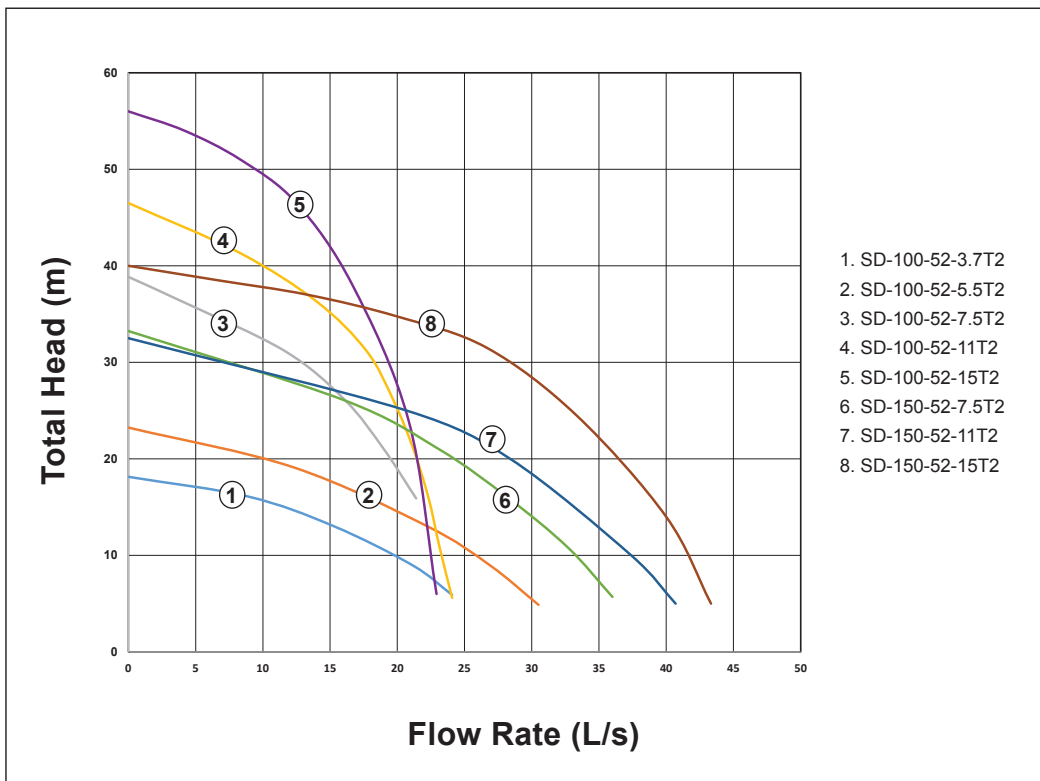
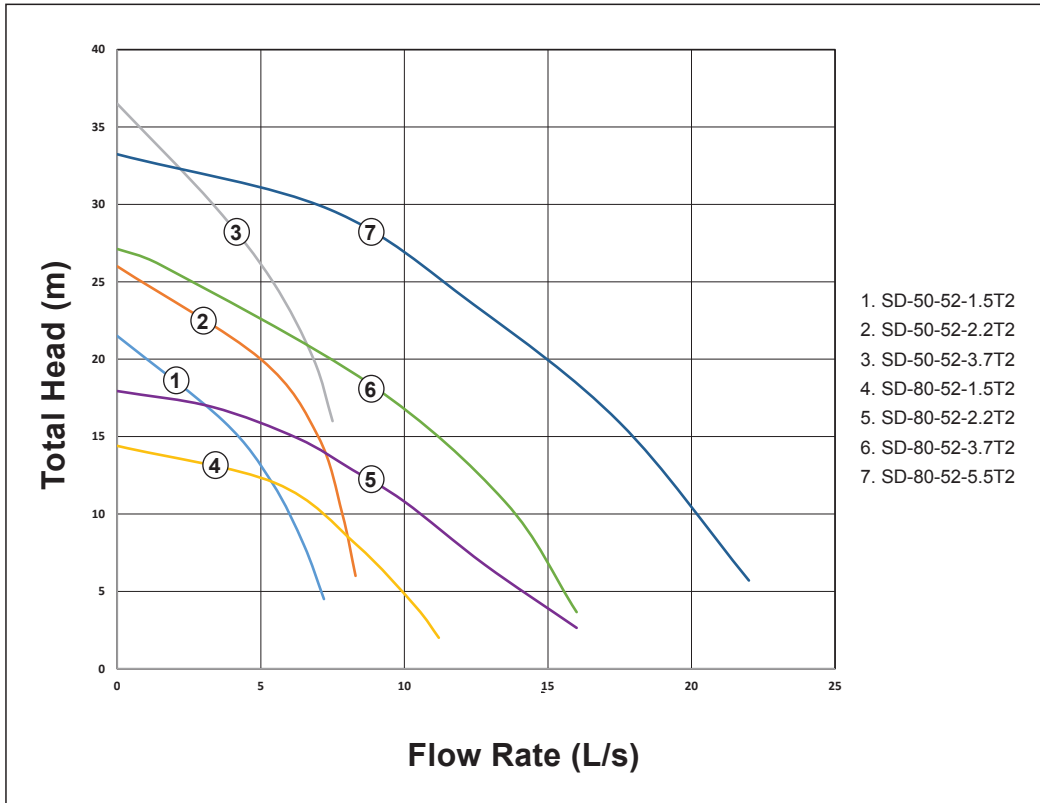

All content is subject to change without notice.

Heavy Duty Submersible Dewatering Drainage Pump 415V

Aquaplus SDA Series 415V pumps are used extensively in applications such as construction dewatering and sump drainage. SDA Series pumps are designed for continuous unattended operation.

Features

- Agitator
- Cast iron casing, ductile iron suction cover and chrome iron impeller
- Built in oil lifter enhances sealing life and performance
- Dual silicon carbide mechanical seals in an oil bath
- Pump can run in horizontal and vertical configurations
- Pump can run in “snore mode”

Applications

- Available for light slurry applications such as pumping concrete, bentonite and pulp
- General construction work
- Civil engineering
- Deep well applications

Specifications

| Model Number | Discharge (mm) | Power (kW) | Voltage (V) | Cable (m) | Max Flow (L/s) | Shut-off Head (m) | Pump Weight (kg) | Max Solid (mm) | Rated current A (415 V) |
|------------------------|----------------|------------|-------------|-----------|----------------|-------------------|------------------|----------------|-------------------------|
| SDA-50-52-2.2T2-20M-O | 50 | 2.2 | 415 | 20 | 8.3 | 25 | 40 | 10 | 5 |
| SDA-80-52-3.7T2-20M-O | 80 | 3.7 | 415 | 20 | 16.7 | 30 | 64 | 10 | 7.7 |
| SDA-80-52-4.0T2-20M-O | 80 | 4 | 415 | 20 | 25 | 15 | 105 | 30 | 9.5 |
| SDA-100-52-6.0T2-20M-O | 100 | 6 | 415 | 20 | 39 | 17 | 145 | 30 | 13 |
| SDA-150-52-9.0T2-20M-O | 150 | 9 | 415 | 20 | 53 | 23 | 170 | 30 | 18 |
| SDA-200-52-22T2-20M-O | 200 | 22 | 415 | 20 | 100 | 32 | 400 | 30 | 41.5 |

Dimensions

2.2kW - 6kW

9kW - 22kW

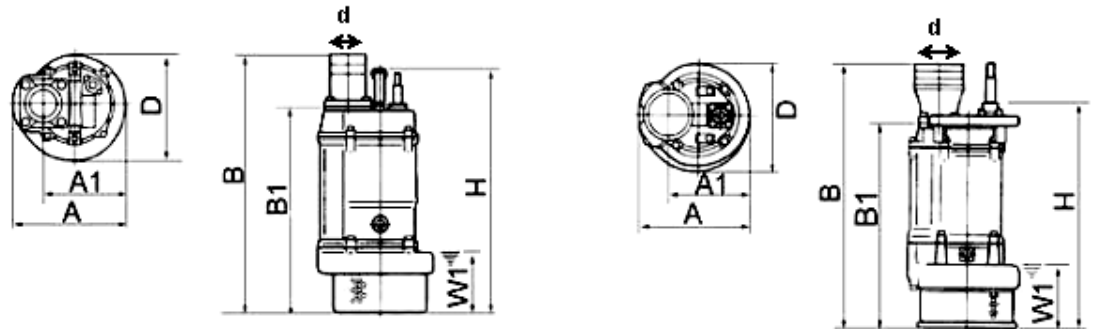

| Model | Dimensions (mm) | | | | | | | |
|------------------------|-----------------|------|-----|-----|------|-----|-----|-----|
| | D | H | A | A1 | B | B1 | W1 | d |
| SDA-50-52-2.2T2-20M-O | 216 | 522 | 235 | 173 | 557 | - | 135 | 50 |
| SDA-80-52-3.7T2-20M-O | 252 | 642 | 283 | 208 | 636 | - | 165 | 80 |
| SDA-80-52-4.0T2-20M-O | 326 | 766 | 350 | 260 | 786 | 666 | 250 | 80 |
| SDA-100-52-6.0T2-20M-O | 373 | 720 | 415 | 305 | 823 | 662 | 263 | 100 |
| SDA-150-52-9.0T2-20M-O | 400 | 768 | 434 | 324 | 872 | 712 | 262 | 150 |
| SDA-200-52-22T2-20M-O | 528 | 1200 | 578 | 442 | 1245 | 970 | 330 | 200 |

Heavy Duty Submersible Dewatering Drainage Pump 415V (cont.)

Performance Curves

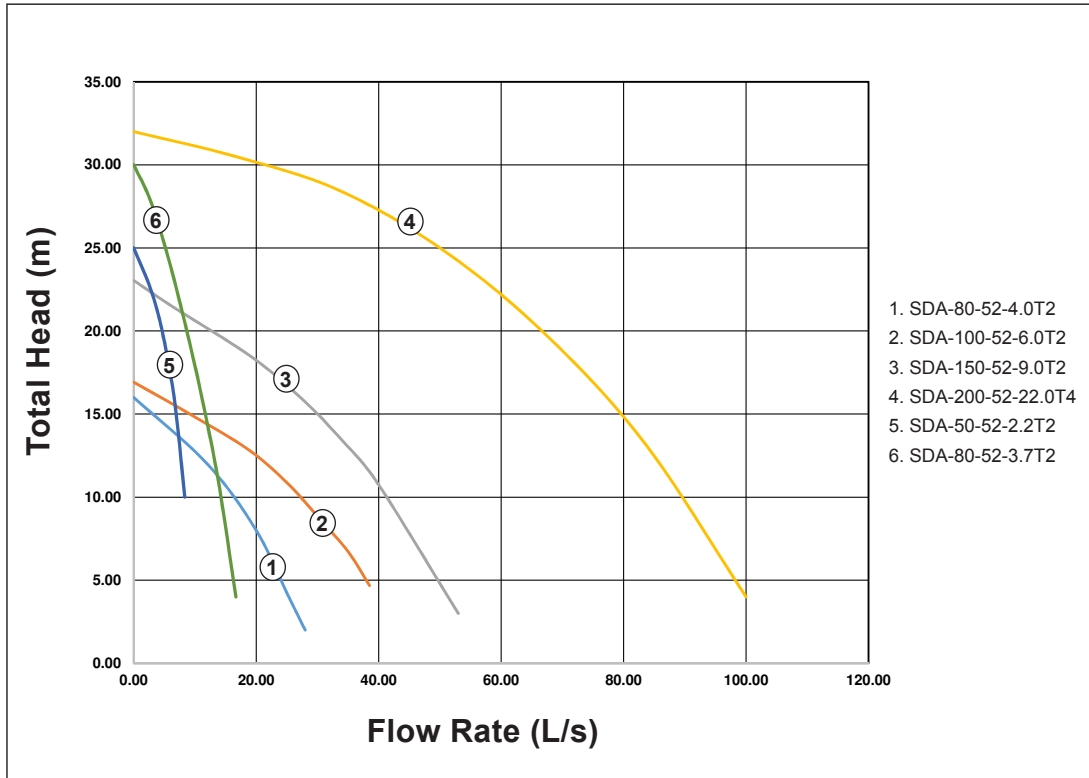

Heavy Duty Submersible Dewatering Pump 415V - High Head High Flow

Aquaplus SDL Series 415V pumps are used in applications such as general construction works, civil engineering, deep well applications and mine site dewatering.

Features

- Cast iron casing, ductile iron suction cover and chrome iron impeller
- Built in oil lifter enhances sealing life and performance
- Dual silicon carbide mechanical seals in an oil bath
- Pump can run in horizontal and vertical configurations
- Pump can run in “snore mode”

Applications

- General construction works
- Civil engineering
- Deep well applications
- Mine site dewatering

Specifications

| Model Number | Discharge (mm) | Power (kW) | Voltage (V) | Cable (m) | Max Flow (L/s) | Shut-off Head (m) | Weight (kg) | Max Solid (mm) | Rated current A (415 V) |
|-----------------------|----------------|------------|-------------|-----------|----------------|-------------------|-------------|----------------|-------------------------|
| SDL-100-52-22T2-20M-C | 100 | 22 | 415 | 20 | 36 | 66 | 365 | 6 | 41.5 |
| SDL-100-52-30T2-20M-C | 100 | 30 | 415 | 20 | 47 | 78 | 370 | 6 | 54 |
| SDL-150-52-22T2-20M-C | 150 | 22 | 415 | 20 | 55 | 50 | 375 | 12 | 41.5 |
| SDL-150-52-30T2-20M-C | 150 | 30 | 415 | 20 | 61 | 56 | 380 | 12 | 54 |
| SDL-150-52-37T2-20M-C | 150 | 37 | 415 | 20 | 61 | 83 | 620 | 6 | 71 |
| SDL-150-52-45T2-20M-C | 150 | 45 | 415 | 20 | 61 | 90 | 640 | 6 | 85 |
| SDL-200-52-37T2-20M-C | 200 | 37 | 415 | 20 | 91 | 48 | 620 | 20 | 71 |
| SDL-200-52-45T2-20M-C | 200 | 45 | 415 | 20 | 102 | 53 | 640 | 20 | 85 |

Dimensions

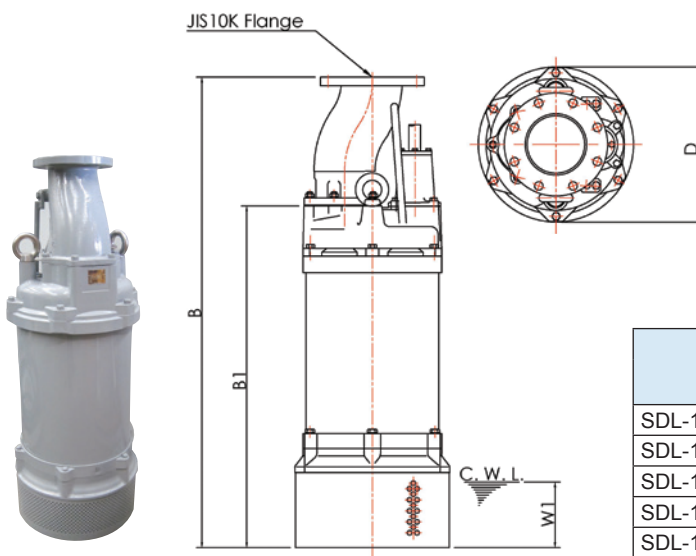

| Model | Dimensions (mm) | | | |
|-----------------------|-----------------|------|------|-----|
| | D | B | B1 | W1 |
| SDL-100-52-22T2-20M-C | 420 | 1315 | 964 | 190 |
| SDL-100-52-30T2-20M-C | 420 | 1355 | 1004 | 190 |
| SDL-150-52-22T2-20M-C | 420 | 1362 | 961 | 190 |
| SDL-150-52-30T2-20M-C | 420 | 1362 | 961 | 190 |
| SDL-150-52-37T2-20M-C | 530 | 1448 | 1027 | 190 |
| SDL-150-52-45T2-20M-C | 530 | 1448 | 1027 | 190 |
| SDL-200-52-37T2-20M-C | 530 | 1448 | 1027 | 190 |
| SDL-200-52-45T2-20M-C | 530 | 1448 | 1027 | 190 |

Heavy Duty Submersible Dewatering Pump 415V - High Head High Flow (cont.)

Performance Curves

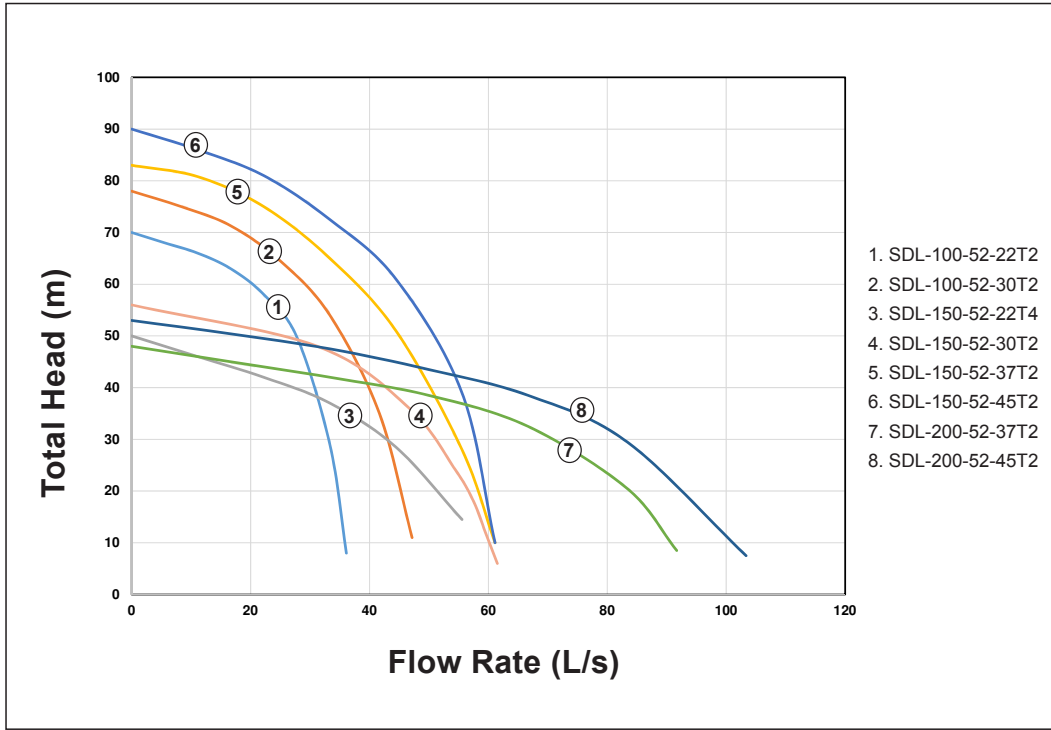

Aquaplus Product Range

ESD Series – End Suction DIN (24255) Pumps

ESI Series – End Suction ISO (2585) Pumps

SP Series – Self Priming Pumps

SD Series – Submersible Dewatering Pumps

AD Series – Air Diaphragm Pumps

MD Series – Magnetic Drive Pumps

FRM Series – Flexible Rising Main (Borehole Pump Hose)

MS Series – Mechanical Seals (Single Spring & Cartridge)

We are also able to provide Progressive Cavity, Peristaltic Pumps, Split Case Pumps and Magnetic Drive Pumps.

The logo for Aquaplus, featuring the word "Aquaplus" in a stylized, blue, italicized font with a wave-like graphic element above the 'A'.

AVAILABLE FROM

For information on these products or for any specialised requirements please contact your local Aquaplus distributor or visit our website at www.aquapluspumps.com.au