

# ***Retro-Fit***

**Pumps**

## **ISP SERIES**

### **Process Pumps**

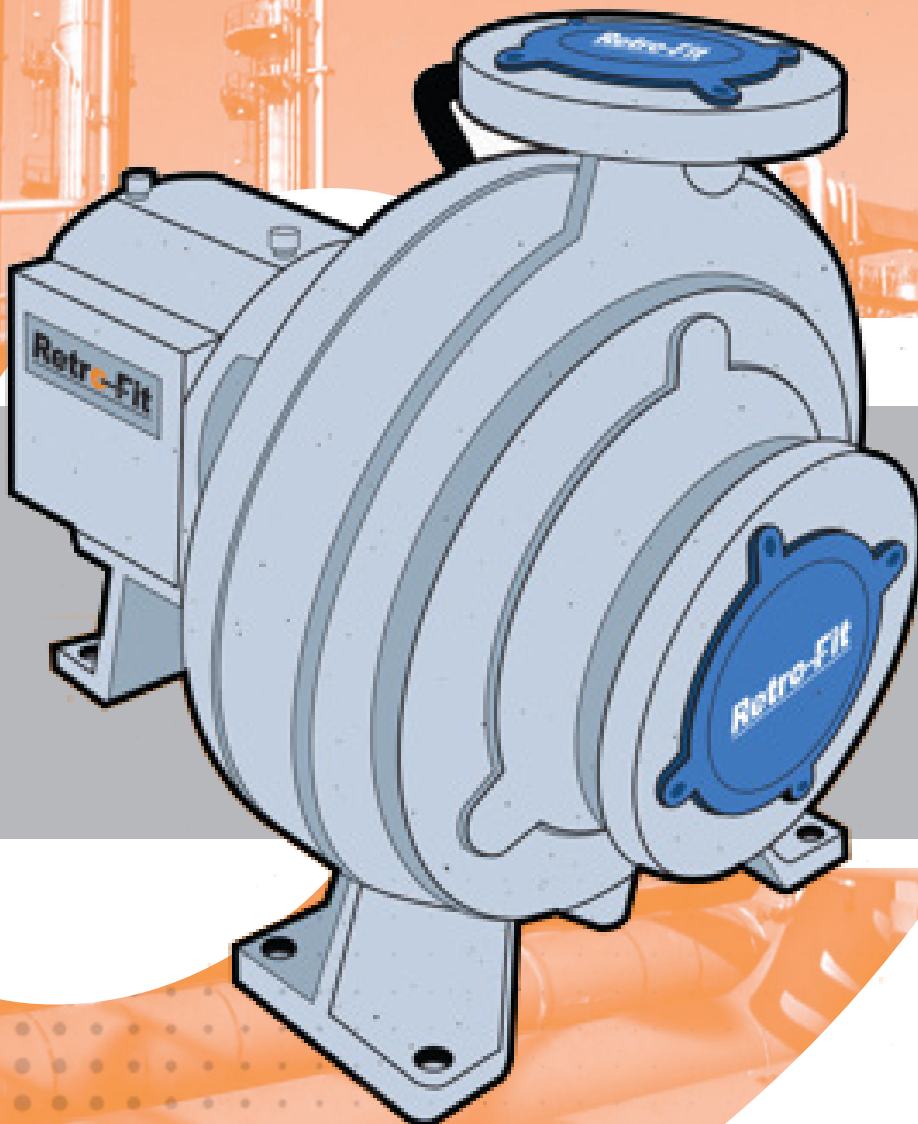

**PROCESS PUMPS**

## General

### Redefining Efficiency and Reliability in Industrial Applications

Malcolm Thompson Pumps is the exclusive distributor of Retro-Fit pumps and pump parts, offering a compelling solution for optimising your specific industrial processes.

The ISP Series process pumps are top-tier products that provide superior performance and reliability. They are engineered to meet the highest industry standards, making them ideal for demanding processes in the mining, chemical, petrochemical, and general industrial sectors.

With their robust construction and advanced design, the ISP Series process pumps offer excellent efficiency, reduced maintenance costs, and enhanced durability. They are the perfect choice for upgrading existing systems, ensuring seamless integration and long-term operational excellence.

### Features

- **Low Maintenance Costs:** The modular design simplifies maintenance tasks and reduces spare part requirements.
- **Trusted Expertise:** Proven track record across a diverse range of industries.
- **Service-Friendly Design:** User-friendly features for a quick and easy installation, with straightforward maintenance and service.
- **Wide Range of Applications:** High-performance hydraulics and material choices for versatility and dependability for the most demanding applications.
- **Advanced Sealing Technology:** Innovative shaft seals that ensure consistent operation and lower maintenance expenses.
- **Self-Priming and Degassing Excellence:** Cutting-edge technology for effortless self-priming and effective degassing.
- **Robust Bearing System:** Durable and straightforward bearing units available with multiple lubrication choices.
- **Modular Design:** Modular construction reduces spare part inventory and associated costs.

### Applications

- For handling pure, raw and stormwater as well as seawater in
- Oil & gas
  - Power generation
  - Water treatment
  - Seawater desalination
  - Marine and offshore engineering
  - Fire fighting systems
  - Industrial water supply
  - Power stations
  - Irrigation and drainage pumping stations
  - Water works
  - Clean and lightly contaminated liquids
  - Viscous liquids
  - Fibrous slurries
  - Large solids containing liquids
  - Gas containing liquids and self-priming applications



Mining



Commercial & Industrial



Gas Production



### Cost Effective Retro-Fit Replacement Pump Parts

- Retro-Fit pump parts offer a reliable and cost-effective solution.
- Our pump parts are interchangeable with leading brands like Sulzer, Ahlstrom, Goulds, and many more.
- Guaranteed compatibility with existing equipment.
- Built to meet or exceed OEM standards for long-lasting performance.

**Shaft Sealing**

**Dynamic Seal**

Dynamic Seal is specially designed for fibrous liquids such as paper stock and other difficult liquids. The Dynamic Seal requires no external sealing water. It is essentially maintenance-free and offers outstanding reliability.

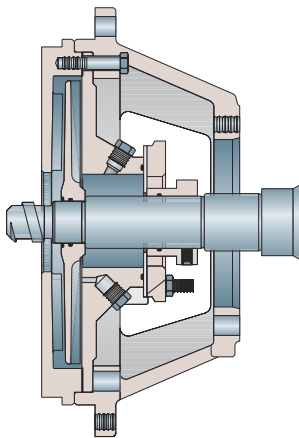

**Mechanical Seal**

Various mechanical seal configurations are available. For difficult applications "ready-fitted" seals are especially recommended. For extremely corrosive applications, a ready-fitted seal can be selected with the same exact construction material as the pump casing itself.

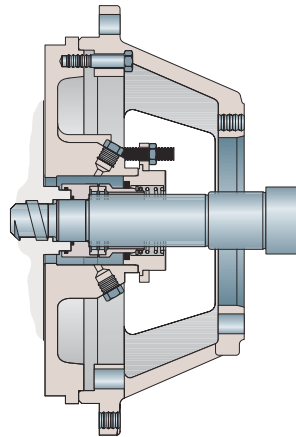

**Gland Packings**

A gland packing with external flushing prevents the pumped liquid from precipitating into the sealing housing. The flushing liquid is mixed with the pumped liquid. Alternatively the external flushing has an outlet connection.

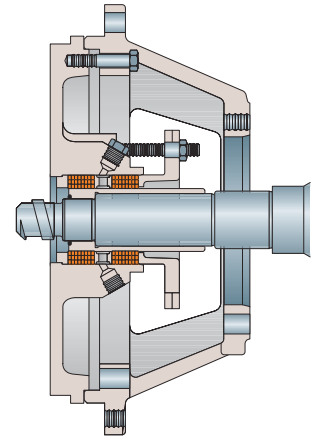

**Features and Benefits**

A double volute casing in larger pumps reduces radial forces and shaft deflection.

The self-venting, top centerline casing prevents air-lock in the top of the casing.

The sideplate is adjusted externally to maintain a constant impeller clearance and continuous high efficiency.

**Hydraulics**

Designed for pumping clean, abrasive or corrosive liquids especially stocks of various kinds.

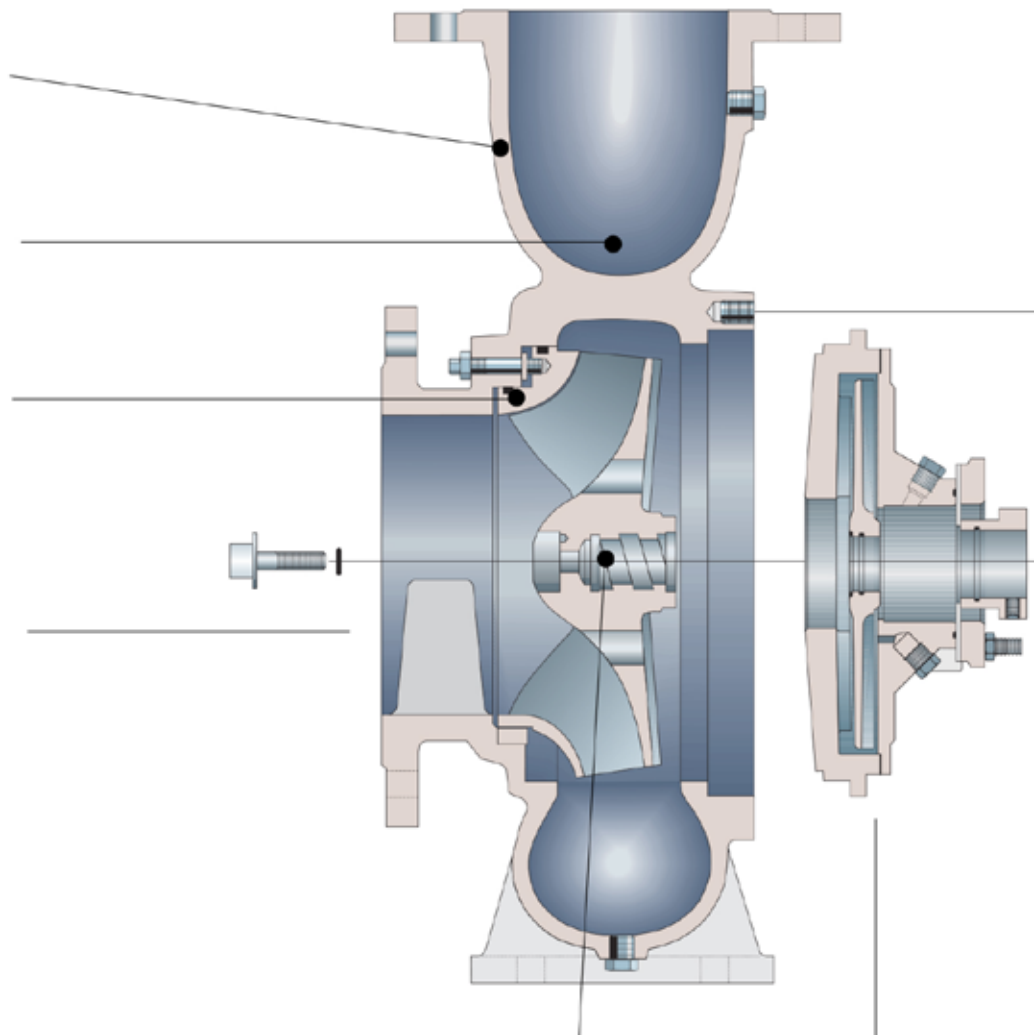

ROTOKEY impeller mounting provides strong, reliable power transmission. It is self-locking and reverse rotation safe. ROTOKEY facilitates the installation and removal of the impeller. It is not sensitive to axial loads created during pump operation

A wide selection of shaft seals is



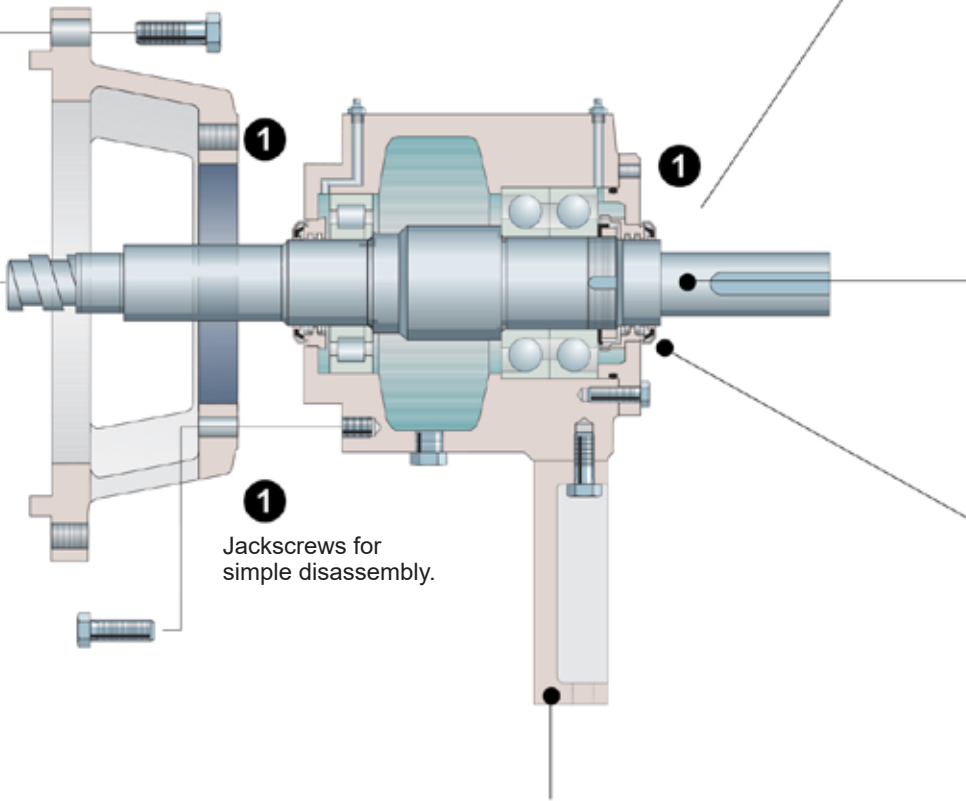

Jackscrews for simple disassembly.

Strong and rigid bearing support foot improves mounting stability and maintains solid support.

### Bearing Unit

Simplified heavy-duty bearing unit design ensures reliability.

### Grease Lubrication

- temperature of pumped liquid max. 120 °C

### Oil Lubrication

- temperature of pumped liquid max. 180 °C

Heavy-duty shaft. Deflection at stuffing box less than 0.05 mm. High strength duplex stainless steel is standard shaft material.

Non-contacting bearing protection for the combined advantages of labyrinth ring, deflector and lipseal. Lipseal protects in standstill position.

**Materials**

**Standard Material Combinations**

Stainless Steel Design			Nominal Chemical Composition %					
			C max.	Cr	Ni	Mo	Cu	N
Duplex SS	ASTM A890 Grade 3A	41	0.06	24.0-27.0	4.0-6.0	1.75-2.50	-	0.15-0.25
	ASTM A890 Grade 1B	4L	0.04	24.5-26.5	4.75-6.00	1.75-2.25	2.75-3.25	-
	ASTM A890 Grade 5A	4T	0.03	24.0-26.0	6.0-8.0	4.0-5.0	-	0.10-0.30
Austenitic SS	ASTM A743 Grade CG-3M	4G	0.03	18.0-21.0	9.0-13.0	3.0-4.0	-	-
	ASTM A743 Grade CN-7M	43	0.07	19.0-22.0	27.5-30.5	2.0-3.0	3.0-4.0	-
Martensitic SS	ASTM A747 Grade CB7Cu-2	4E	0.07	14.0-15.5	4.5-5.5	-	2.5-3.2	-
<b>Other Design</b>								
Nickel Alloy	A494CW-6M	4J	0.07	17.0-20.0	balance	17.0-20.0		
<b>Cast Steel Design</b>								
Cast Steel material	ASTM A216-93 Grade WCB	46	0.30	-	-	-		
<b>Material Alternatives for Other parts</b>								
Gasket material	Klinger SIL C-4430	83	Used in temperature range -40...+160 °C and pH 2-12					
	PTFE/Glass	84	Used in temperature range -190...+240 °C and pH 0-14					
O-ring material	EPDM	92	Used in temperature range -50...+150 °C					
	FKM	96	Used in temperature range -20...+210 °C					

Other corrosion resistant cast steels available on special request.

**Corrosive Resistant Thinking**

To ensure maximum reliability against corrosion we offer material selection options from high quality steel foundries.

- All parts in contact with the pumped liquid can be produced from the same construction material as the pump casing. Materials available for this option are 41, 4L, 4T, 4G, 43, and 4J

**Main Dimensions**

**Dimensions:** ISO 2858 (up to size 200-400) Specifications  
 Stuffing box ISO 3069  
 Flange drilling Several flange drilling options according to valid standards.

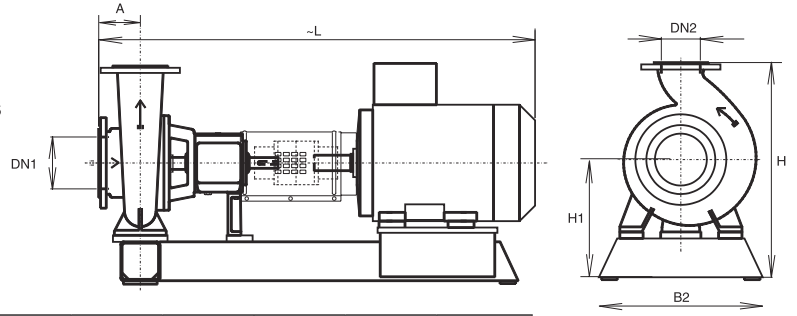

Size	DN1	DN2	B2 <sup>1)</sup>	H <sup>1)</sup>	L <sup>1)</sup>	A	H1	Weight kg <sup>2)</sup>
ISP32-200	50	32	500	480	1240	80	300	125
ISP40-200	65	40	500	480	1260	100	300	125
ISP50-200	80	50	630	540	1330	100	340	160
ISP65-200	100	65	630	640	1580	100	415	230
ISP80-200	125	80	630	665	1600	125	415	240
ISP32-250	50	32	630	620	1490	100	395	230
ISP40-250	65	40	630	670	1710	100	445	250
ISP50-250	80	50	630	640	1600	125	415	235
ISP65-250	100	65	720	730	1820	125	480	275
ISP80-250	125	80	720	760	1820	125	480	280
ISP40-315	65	40	630	740	1700	125	460	280
ISP50-315	80	50	720	800	2020	125	520	350
ISP100-250	125	100	730	835	2290	140	555	420
ISP125-250	150	125	730	910	2290	140	555	430
ISP150-250	200	150	630	840	1670	160	465	340
ISP65-315	100	65	730	835	2270	125	555	420
ISP80-315	125	80	730	870	2270	125	555	410
ISP100-315	125	100	730	915	2400	140	600	480
ISP125-315	150	125	730	955	2400	140	600	500
ISP100-400	125	100	720	820	1780	140	465	370
ISP125-400	150	125	720	900	1860	140	500	400
ISP200-250	250	200	730	980	2100	200	530	510
ISP300-250	300	300	730	1175	2150	225	615	630
ISP150-315	200	150	730	930	2100	160	530	460
ISP200-315	250	200	730	980	2100	180	530	500
ISP250-315	300	250	830	1175	2600	225	615	660
ISP300-315	350	300	880	1365	2700	250	735	870
ISP150-400	200	150	830	1005	2350	160	555	570
ISP200-400	250	200	880	1175	2650	180	675	740
ISP250-400	300	250	880	1295	2850	200	735	840
ISP300-400	350	300	1160	1440	2900	250	770	1060
ISP350-500	400	350	880	1645	2900	280	845	1190
ISP400-500	400	400	1160	1770	2900	280	920	1420
ISP100-500	200	100	880	1185	2700	180	685	740
ISP150-500	250	150	880	1185	2800	180	685	780
ISP200-500	250	200	1160	1330	2800	180	770	1000
ISP250-500	300	250	1160	1400	2850	200	770	1060
ISP300-500	350	300	1160	1590	3100	250	920	1110
ISP400-600	500	400	1160	1850	3000	355	1000	1600
ISP500-600	500	500	1160	2000	3000	355	1000	1780
ISP100-625	200	100	1160	1330	2850	250	770	1130
ISP200-600	300	200	1160	1415	2820	200	785	1250
ISP250-600	300	250	1160	1495	2850	225	785	1330
ISP300-600	400	300	1160	1645	2870	250	845	1410
ISP500-700	500	500	1340	2100	3180	400	1100	2350
ISP600-700	600	600	1340	2280	3180	420	1100	2350
ISP400-750	500	400	1340	1960	3135	355	1010	2020

1) Max. dimensions for biggest IEC-motor required in standard operation  
 2) With biggest steel baseplate and coupling but without motor. available with both metric and US standard dimensions with compatible fasteners and fittings. NOTE! Dimensions not to be used for construction.



# ***Retro*—*Fit***

**Pumps**

Proudly Distributed by:



1800 733 687 | [mtp.com.au](http://mtp.com.au) | [sales@mtp.com.au](mailto:sales@mtp.com.au)

**PERTH**  
1st Floor, Unit 1/33  
Colquhoun Road  
Perth Airport, WA 6105

**SYDNEY**  
26 Prince Williams Drive  
Seven Hills, NSW 2147

