

TECHNICAL SPECIFICATIONS



ISP Process Pumps - ISP350-500 (400-350-500)

ISP Impeller 283894 OPEN B85 Z6

ARP: Impeller 285275 OPEN B85 Z6, please add the power demand of the degassing unit = 1.3 kW

ASP: Impeller 285275 OPEN B85 Z6, please add the power demand of the degassing unit = 2.0 kW

Performance Curve - ISP350-500-O-740

740 rpm

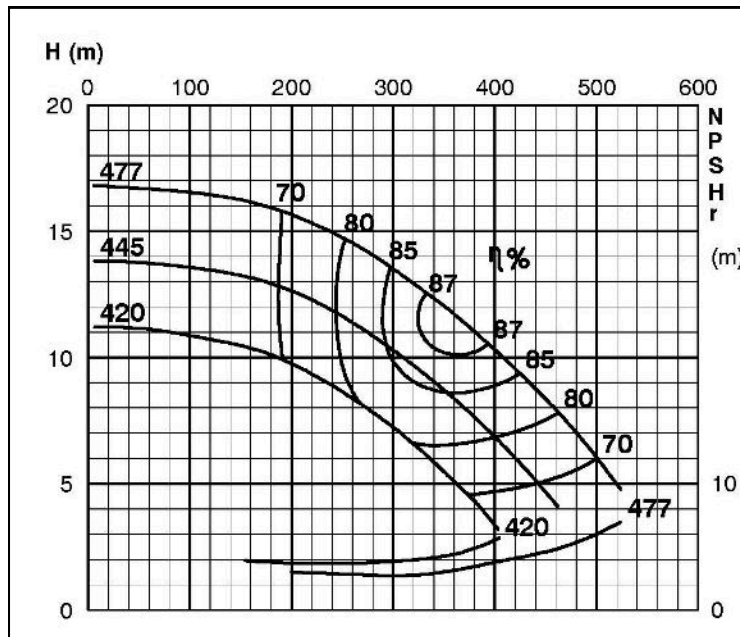

| IMPELLER DIA | | |
|----------------------|----|----------|
| Ød ₂ (mm) | K° | Øda (mm) |
| 477 | 13 | 438.7 |
| 475 | 13 | 436.4 |
| 470 | 13 | 431.2 |
| 465 | 13 | 426.0 |
| 460 | 13 | 420.5 |
| 455 | 14 | 411.9 |
| 450 | 14 | 406.9 |
| 445 | 15 | 398.1 |
| 440 | 16 | 389.3 |
| 435 | 17 | 380.3 |
| 430 | 18 | 371.2 |
| 425 | 19 | 362.0 |
| 420 | 20 | 353.0 |

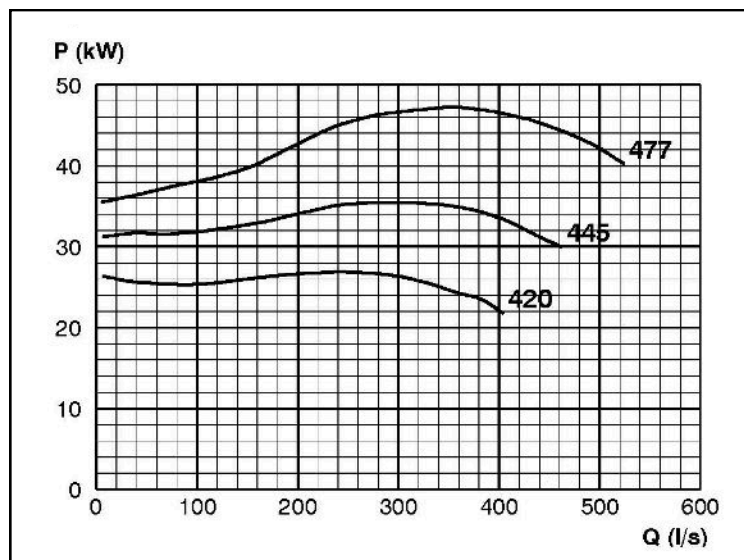
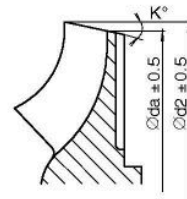

RET13927