

# Retro-Fit

Pumps

## TECHNICAL SPECIFICATIONS



ISP Process Pumps - ISP400-750 (500-400-750)

ISP Impeller 289035 OPEN B76 Z6

ISRP: Impeller 289207 OPEN B76 Z6, please add the power demand of the degassing unit = 2.8 kW

### Performance Curve - ISP400-750-O-740

740 rpm

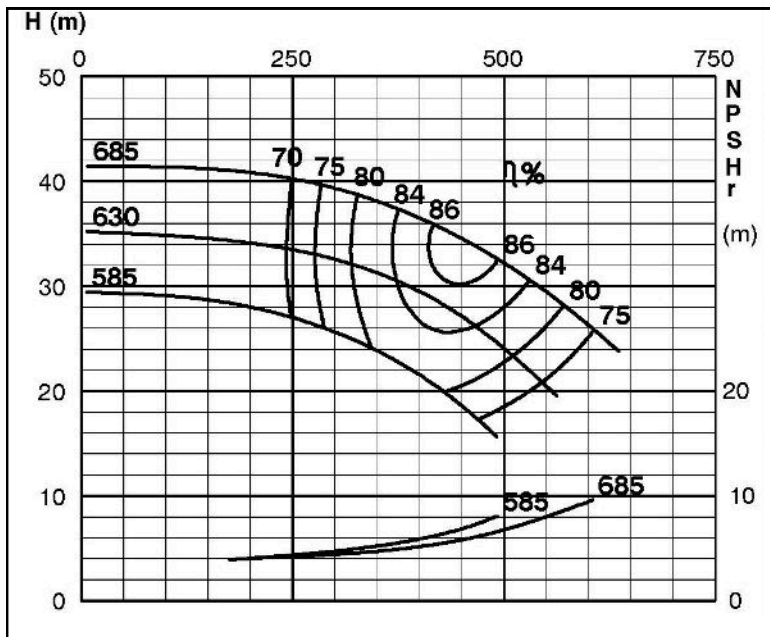

IMPELLER DIA		
$\odot d_2$ (mm)	K <sup>2</sup>	$\odot d_a$ (mm)
885		
880		
875		
870		
865		
860		
855		
850		
845		
840		
835		
830		
825		
820		
815		
810		
805		
800		
595	1	582.1
590	1	587.1
585	2	579.1
580	2	574.0
575	3	568.0
570	3	560.8
565	4	552.7
560	5	544.5
555	5	539.4
550	6	531.1

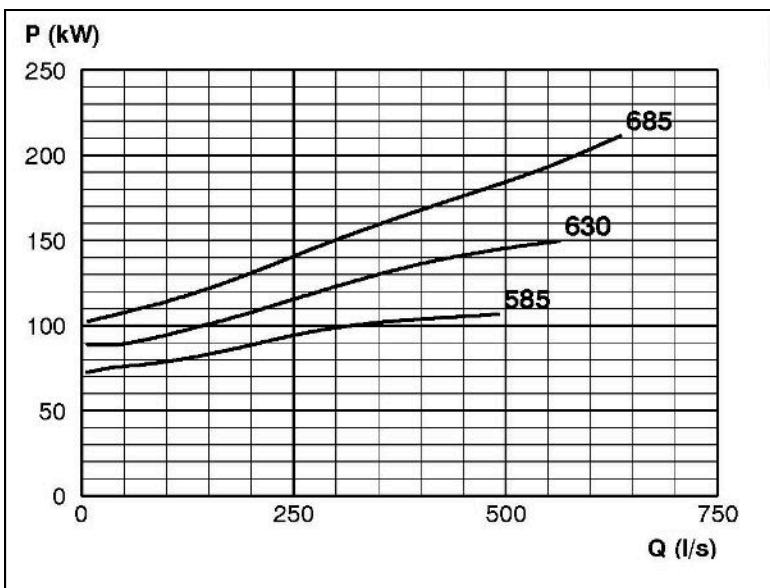
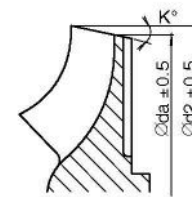
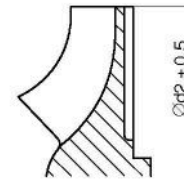

RET13945